

**WET-CON SERIES
IL-MP
(12 - 16 contacts)**

WET-CON In-Line Connector Male Plug
Mates with BH-FS and IL-FS
Dummy Connector: DC-FS

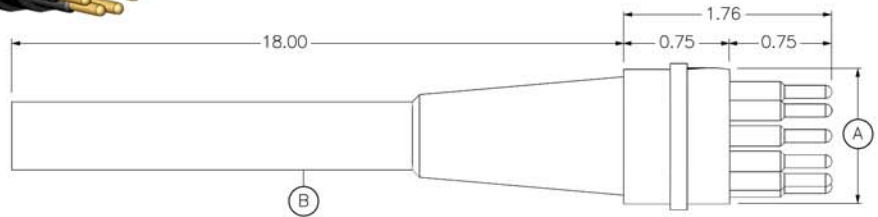

CONNECTOR	A - Ø (INCHES)	B - CABLE
IL-12-MP	1.60	18/12 SO
IL-16-MP	1.60	18/16 SO

**WET-CON SERIES
IL-FS
(12 - 16 contacts)**

WET-CON In-Line Connector Female Socket
Mates with BH-MP and IL-MP
Dummy Connector: DC-MP

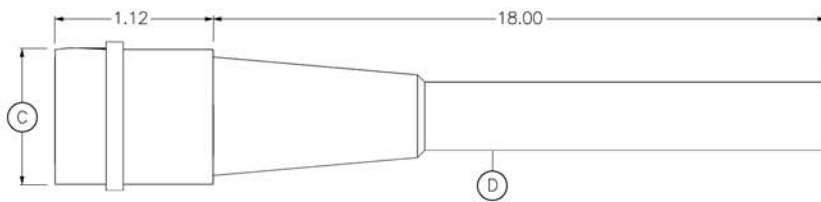

CONNECTOR	C - Ø (INCHES)	D - CABLE
IL-12-FS	1.60	18/12 SO
IL-16-FS	1.60	18/16 SO

NOTES:

- IL-16-MP WOC is not available, substitute with BH-16-MP.
- Locking Sleeve: Optional (see page 10).
- Dummy Connector: Optional.
- Connectors must be lubricated prior to mating.
- Shorting plugs are available should you require the ability of looping together 'like' circuits for testing purposes within the dummy. Pin to pin shorting details need to be supplied at time of order placement.